

## **Arrival information**

### **Arriving by plane:**

After arrival to Budapest Liszt Ferenc International Airport, you can use public transport between 4 a.m. and 22.30 p.m. to reach your accommodation; it takes about 60-70 minutes. To use the public transportation services in Budapest, the best option is to buy “Monthly Budapest pass for Students” which will be valid for your whole stay. This pass is valid for all services EXCEPT FOR the airport express bus 100E.

There is a special express bus from the airport to the city center: bus 100E – the monthly student pass is NOT VALID here; you must buy a separate special ticket to use this bus (1500 HUF – about 4 EUR). Otherwise, the student pass can be used for any other buses, trams, metro lines, etc., see further details on the link below.

### **You have to buy all tickets/passes before you get on the bus, metro, tram, etc.**

The cheapest option to use public transportation is to buy “Monthly Budapest pass for Students” <https://bkk.hu/en/monthly-budapest-pass-for-students-2/> You can use this for unlimited travel on public transport throughout the week. Please make sure you have your student ID with you to use this option! (Be careful! There is another one called “Monthly Budapest pass for Pupils” – this is only valid for elementary school pupils, DO NOT buy this one!)

You can use a credit card to buy tickets and passes at BKK vending machines or at BKK Customer Service Desks (check pictures below). We do not suggest you to change currency at the airport, as they work with high rates. You can find many currency change offices in the city, or use your credit cards in most places.



If you happen to arrive before 4 a.m. or after 22:30 p.m. you can use a taxi or the MiniBUD service to reach your accommodation, they cost around 20-30 EUR per car – you can share this cost if there are more of you in the same car. Both services are totally safe, so is the public transport.

**City Tour on Saturday, March 15<sup>th</sup>, 2025 at 11 am (Mentors will send you detailed info)**

You will need to use your monthly student pass or 2 single tickets DURING the city tour, so please have them ready by the beginning of the tour meeting.

The city tour takes approximately 3 hours, so we suggest you to prepare with some snacks and drinks for yourselves.

## **Getting to BME University**

BME12 course will be held in the main building of BME University, Building K.

**Address: H-1111 Budapest, Műegyetem rakpart 3.**

You need to bring your laptop or tablet for the course

### **BME Building K:**



Efficient Energy Supply of Buildings and District Heating course location:  
Room K 72 (= Building K, basement, room no. 72)

**SEE the MAP below:**

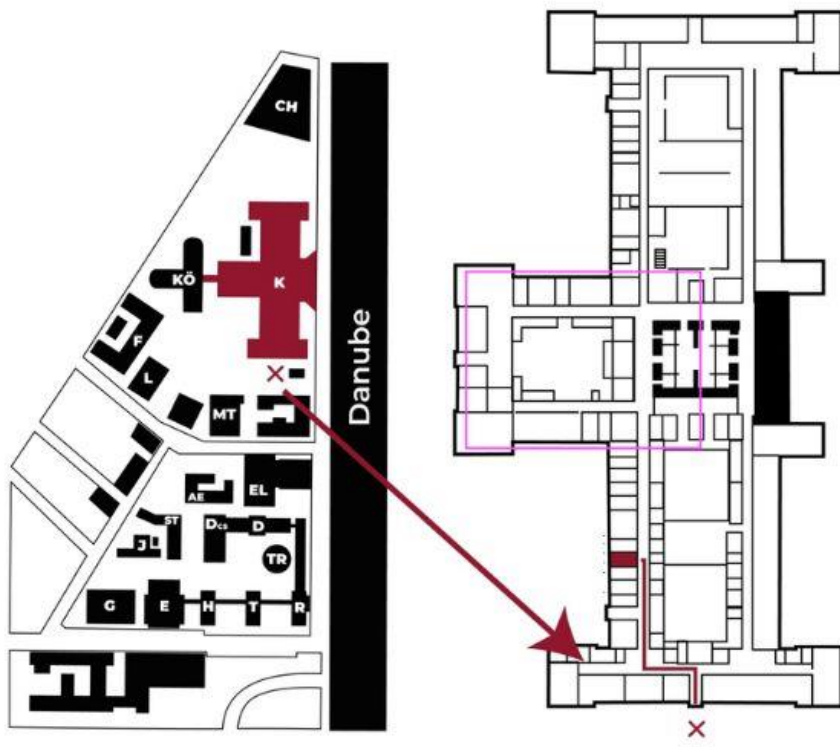

**K Building  
Ground floor  
Room: 73**